

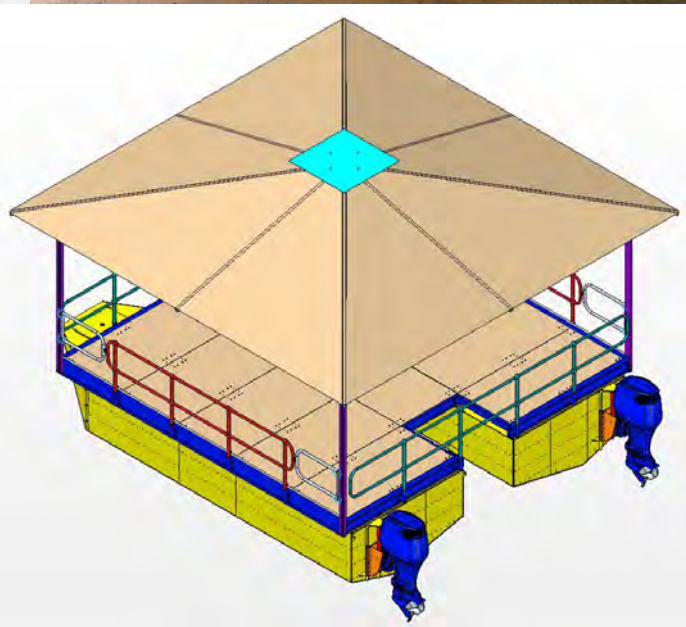

AST

African Spirit Trading 14 (Pty) Ltd

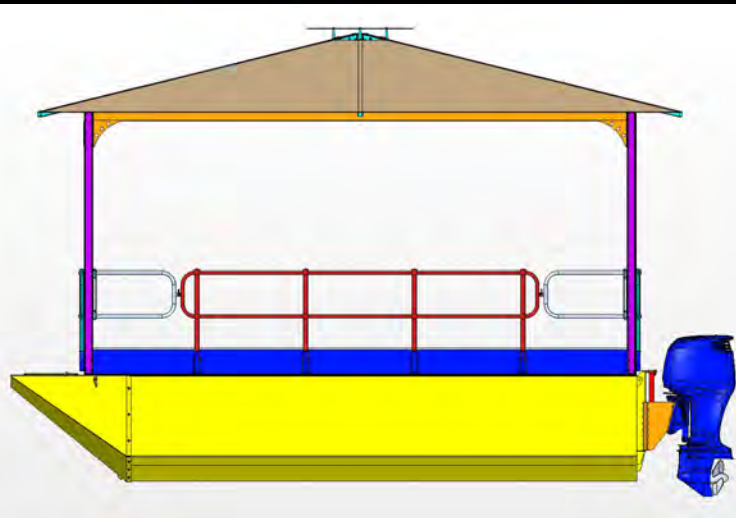

DIAMOND RECOVERY BARGES

AFRICAN SPIRIT TRADING – DIMAOND RECOVERY BARGES (“DRB”)

- Diamond Recovery Barges are designed and built by AST for use on inland water ways to act as floating platforms in support of alluvial diamond recovery operations.
- The 37 m² platform is bolted onto two pontoons each weighing 2.6 tons. The pontoons are fabricated from 5mm steel plate, coated in one layer of marine guard undercoat and two layers of marine cover paint. The complete barge has a total weight of 8.2 tons, and is able to take payloads of up to 15 tons.
- Ergonomically shaped pontoon “cones” are the fuel tanks for the barge, each cone capable of holding 1,350 litres of fuel, allowing the barge to operate autonomously for extended periods time.



The barge is powered by two 90 Hp two stroke outboard motors fitted with power propellers. The barge is fitted with a hydraulic assisted steering mechanism.



- The barge is designed to be easily transportable. The complete barge can be transported in 1 x 40” high volume container. Access to remote locations is greatly simplified by the modular design.
- Final assembly requires no welding, just simply bolting down the beams and slats to join the two pontoons together, the hand rails and canopy support fit into the designated slots on the deck. The canvas roof is then pulled into place and tied down. With the motors bolted on, the plywood floor panels dropped into place, the barge is ready to be pushed onto the waterway.

AST CAN SUPPLY THE FOLLOWING EQUIPMENT

- Gravel pumps with pump capacities ranging from 50m² up to 700m² per hour
- On board classifiers
- HDPE pipe from 100mm ID to 500m ID with custom designed floats allowing for the recovery of the diamondiferous gravels to be delivered directly to the land based diamond recovery plants
- Diesel generators ranging in size from 20KVA up to 1 MVA
- Diving equipment, Dive compressors
- Service Boats
- River bottom sonar profiling
- Fuel Bowsers
- DPP (Diamond Processing Plants)
- Auto Sorting (diamond X-ray treatment plants)
- Modular housing
- Commercial diesel filtration systems, from inline engine water separator/filters, to modular diesel filter plants capable of filtering total on-mine storage depots



SPECIFICATIONS & KIT

- **PUMPING CAPACITY**
 - 12/10" Pump: 800 m³ /hr at 60% solids (480 tph.)
 - 10/8" Pump: 350 m³ /hr at 60% solids (210 tph.)
 - Down to 50 tph
- **DIMENSIONS**
 - Platform: 6.00m x 6.15m. 36.90m² (397ft²)
 - Roof: 8.20m x 8.20m. 67.24m² (724ft²)
 - Platform to roof clearance: 3.00m
 - Complete barge fits in 1 x 40" container
- **TOTAL MASS & PAYLOAD**
 - Each Pontoon mass : 2.7 tonnes
 - Complete Barge mass: 8.2 tonnes
 - Payload: 7 to 12 tonnes
- **BARGE WATER CLEARANCE**
 - No load: 750 mm
 - Loaded: 500 mm
 - Power: 2 x 90 HP Outboard motors



CAD DRAWINGS

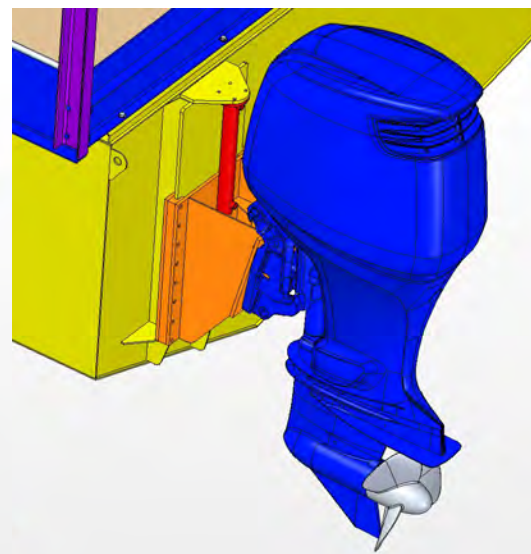
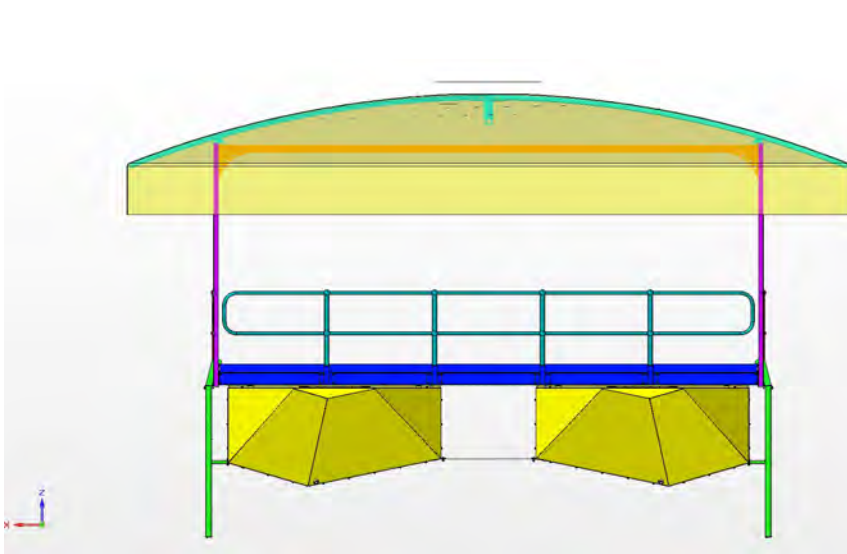
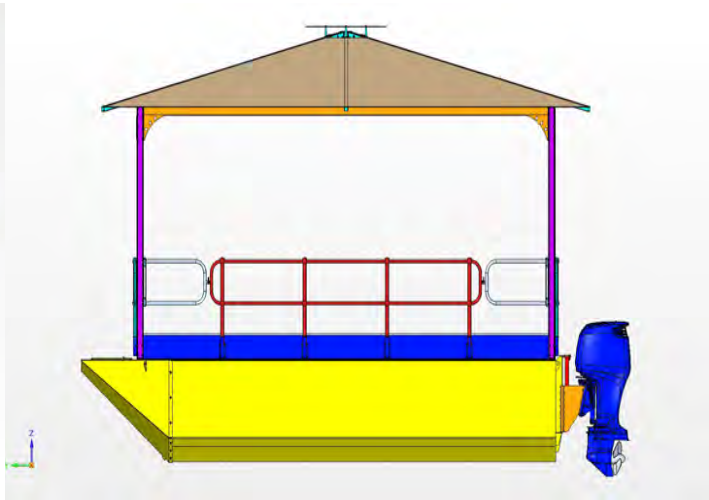
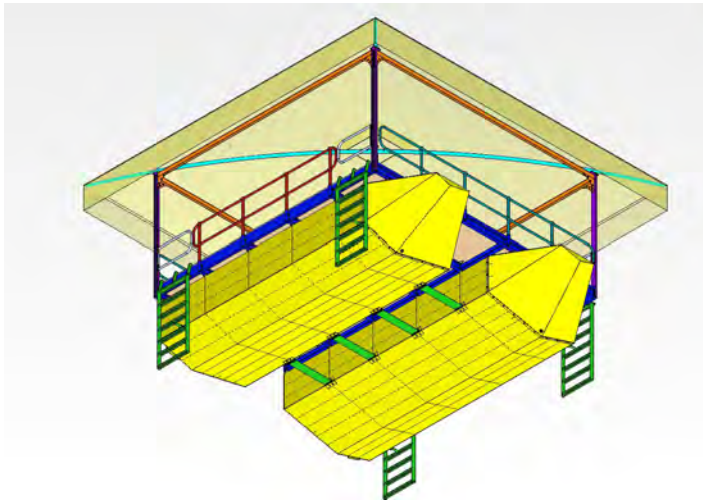
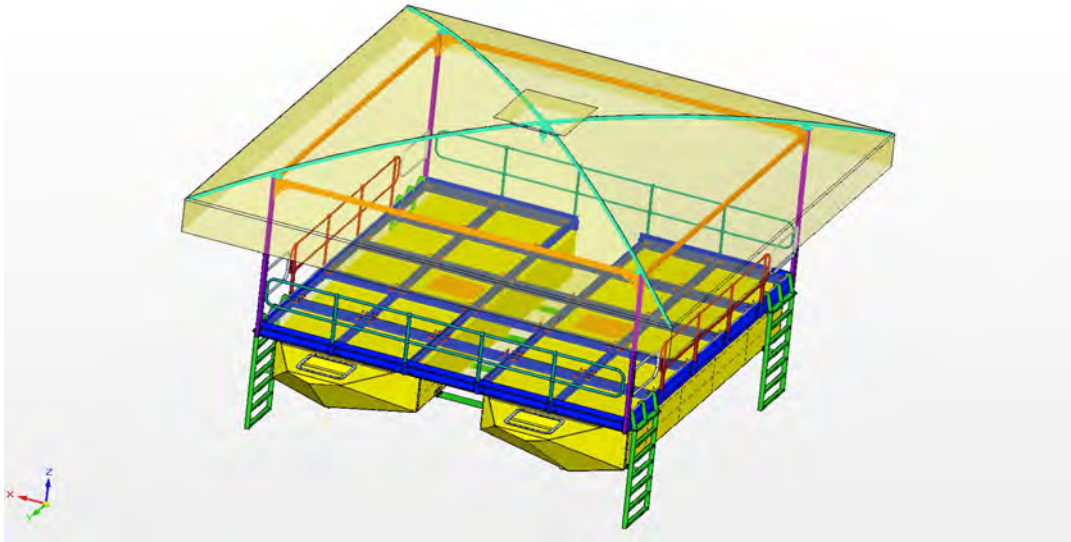



AST

African Spirit Trading 14 (Pty) Ltd

CONTACT US



IAN ROSS

Skype: [ianross725](https://www.skype.com/user/ianross725)

Email: ian.ross@ast14.com

Tel: +27 846 569 862

ED MAGAN

Skype: [edmagan](https://www.skype.com/user/edmagan)

Email: ed.magan@ast14.com

Tel: + 27 736 524 556

WWW.AST14.COM

DIAMOND RECOVERY BARGES